

Discription

The SM712 protects sensitive semiconductor components from damage or upset due to electrostatic discharge (ESD) and other voltage induced transient events. Excellent clamping capability, low leakage, low capacitance, and fast response time provide best in class protection on designs that are exposed to ESD. It gives designer the flexibility to protect one bi-directional line in applications where arrays are not practical.

Features

- ★ Low capacitance.
- ★ Low clamping voltage.
- ★ ESD protection
- ★ Complies with IEC 61000-4-2 standards: Air discharge: ± 30kV
 Contact discharge: ± 30kV
- ★ We declare that the material of product compliance with RoHS requirements and Halogen Free.

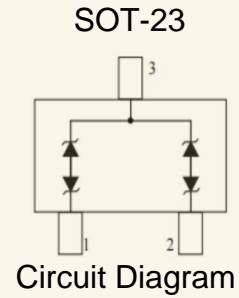

Ordering information

Product ID	Pack	Marking
SM712	SOT-23	SM712

Absolute Ratings (T_{amb}=25°C)

Symbol	Parameter	Value	Units	
P _{PP}	Peak Pulse Power (t _p = 8/20μs)	400	W	
T _L	Maximum lead temperature for soldering during 10s	260	°C	
T _{stg}	Storage Temperature Range	-55 to +150	°C	
T _{op}	Operating Temperature Range	-55 to +125	°C	
T _j	Maximum junction temperature	150	°C	
	IEC61000-4-2 (ESD)	air discharge contact discharge	± 15 ± 8	KV
	IEC61000-4-4 (EFT)		17	A

Electrical Characteristics Ratings at 25°C ambient temperature unless otherwise specified.

Characteristic	Symbol	MIN	MIN	MAX	Unit
Reverse stand-off voltage (Pin 1、 2 to Pin 3) (Pin 3 to Pin 1、 2)	VRWM	-	-	12 7	V
Reverse breakdown voltage (IT = 1 mA, Pin 1、 2 to Pin 3) (IT = 1 mA, Pin 3 to Pin 1、 2)	VBR	13.3 7.5	- -	- -	V
Reverse leakage current (VR = VRWM, Pin 1、 2 to Pin 3) (VR = VRWM, Pin 3 to Pin 1、 2)	IR	- -	- -	100 200	nA
Clamping Voltage (IPP = 10A (8 x 20µs pulse), Pin 1、 2 to Pin 3) (IPP = 10A (8 x 20µs pulse), Pin 3 to Pin 1、 2)	VC	- -	- -	12 20	V
Junction Capacitance (VR = 0V, f = 1MHz, Pin 1、 2 to Pin 3) (VR = 0V, f = 1MHz, Pin 3 to Pin 1、 2)	CJ	- -	- -	75 75	pF

Typical Characteristics

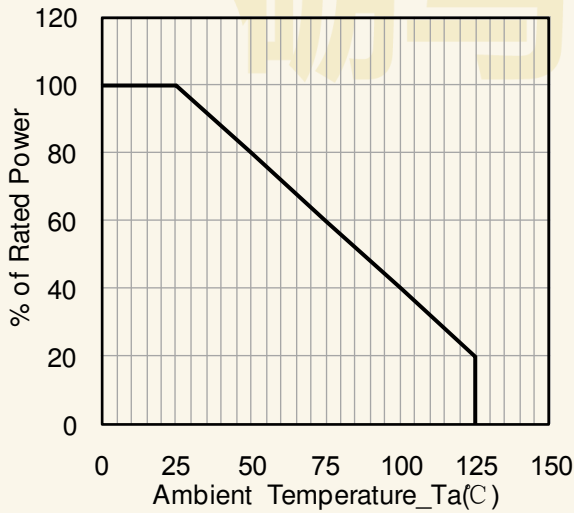

Figure 1. Power Derating Curve

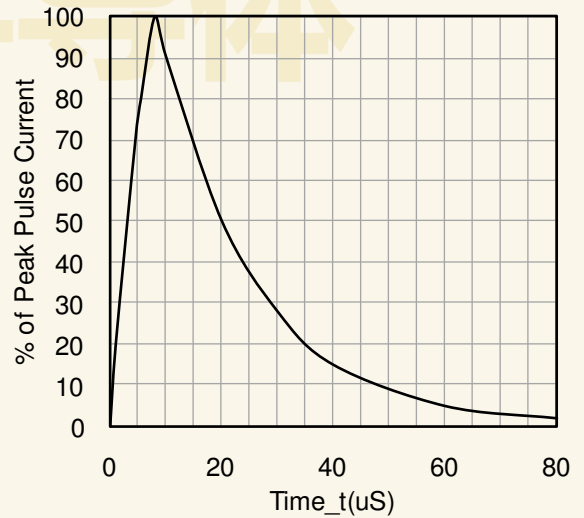

Figure 2. 8 X 20uS Pulse Waveform

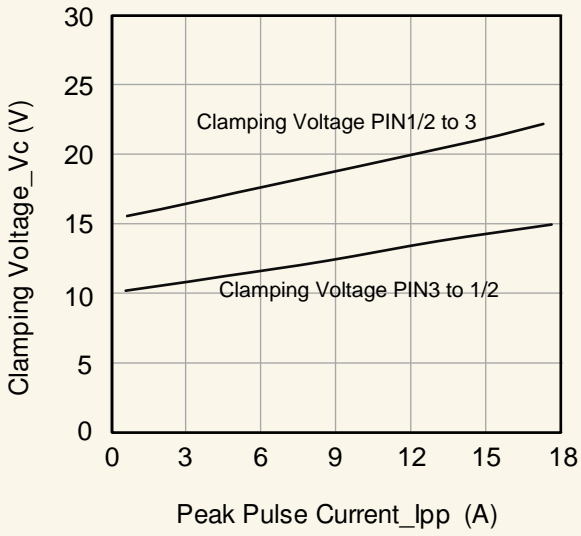

Figure 3. Clamping Voltage vs. Peak Pulse Current

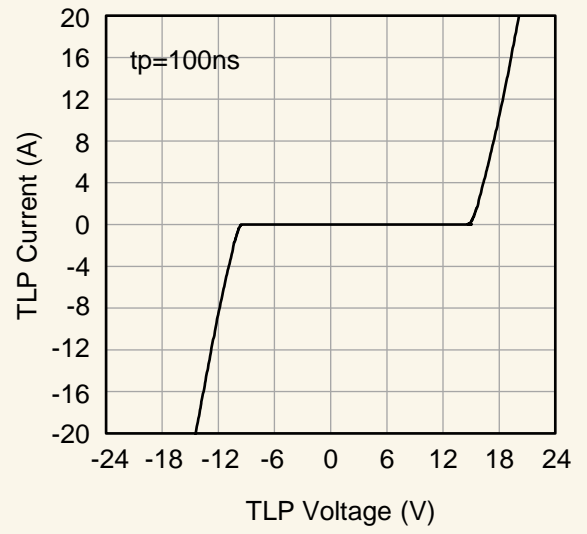
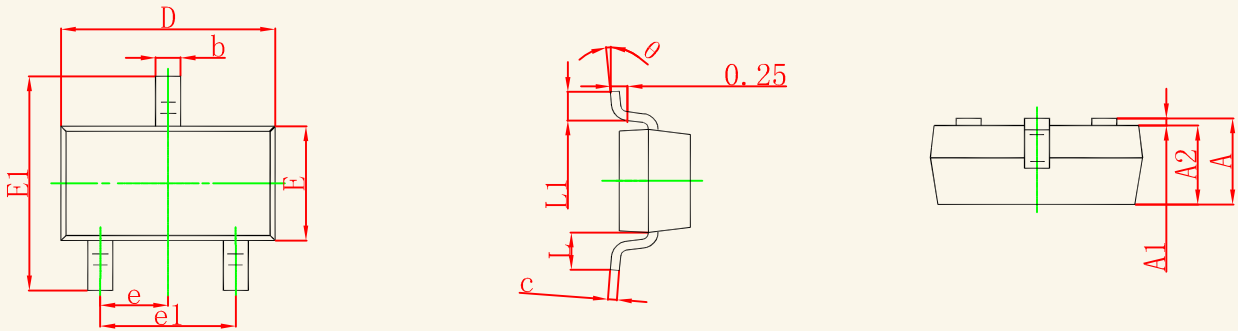

Figure 4. TLP Measurement

LMSEMI
砺马半导体

SOT-23 Package Outline Dimensions



Symbol	Dimensions In Millimeters		Dimensions In Inches	
	Min	Max	Min	Max
A	0.	1.	0.	0.045
A1	9000.	1500.	0350.	0.004
A2	0000.	1001.	0000.	0.041
b	9000.	0500.	0350.	0.020
c	3000.	5000.	0120.	0.006
D	0802.	1503.	0030.	0.118
E	8001.	0001.	1100.	0.055
E1	2002.	4002.	0470.	0.100
e	0.950 TYP		0.037 TYP	
e1	2501.	5502.	0890.	0.079
L	0.550 REF		0.022 REF	
L1	8000.	0000.	0710.	0.020
θ	300 0°	500 8°	012 0°	8°

SOT-23 Suggested Pad Layout

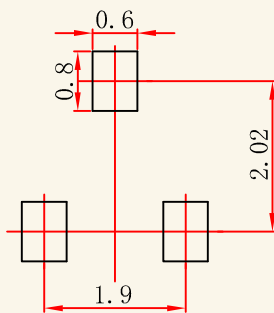

Note:

1. Controlling dimension: in millimeters.
2. General tolerance: $\pm 0.05\text{mm}$.
3. The pad layout is for reference purposes only.

SOT-23 Reel

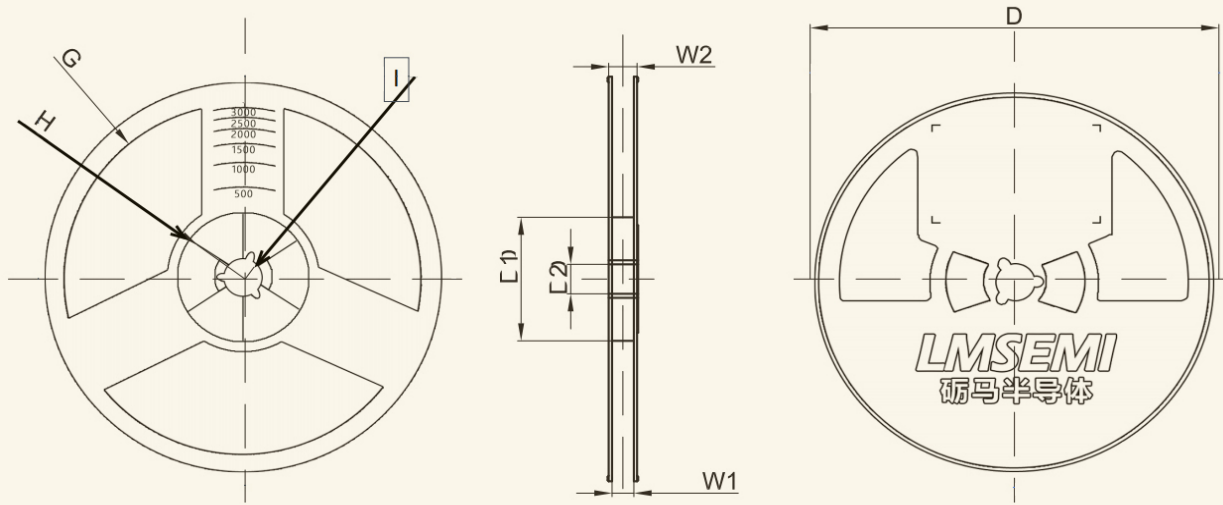

Dimensions are in millimeter

Reel Option	D	D1	D2	G	H	I	W1	W2
7" Dia	Ø178.00	54.40	13.00	R78.00	R25.60	R6.50	9.50	12.30

REEL	Reel Size	Box	Box Size(mm)	Carton	Carton Size(mm)	G.W.(kg)
3000 pcs	7 inch	30,000 pcs	183×126×183	180,000 pcs	395×380×200	

砺马半导体

NOTICE

LMSEMI reserves the right to make modifications, enhancements, improvements corrections or other changes without further notice to any product herein. LMSEMI does not assume any liability arising out of the application or use of any product described herein.